

# EAGLE RIVER 62F618HS

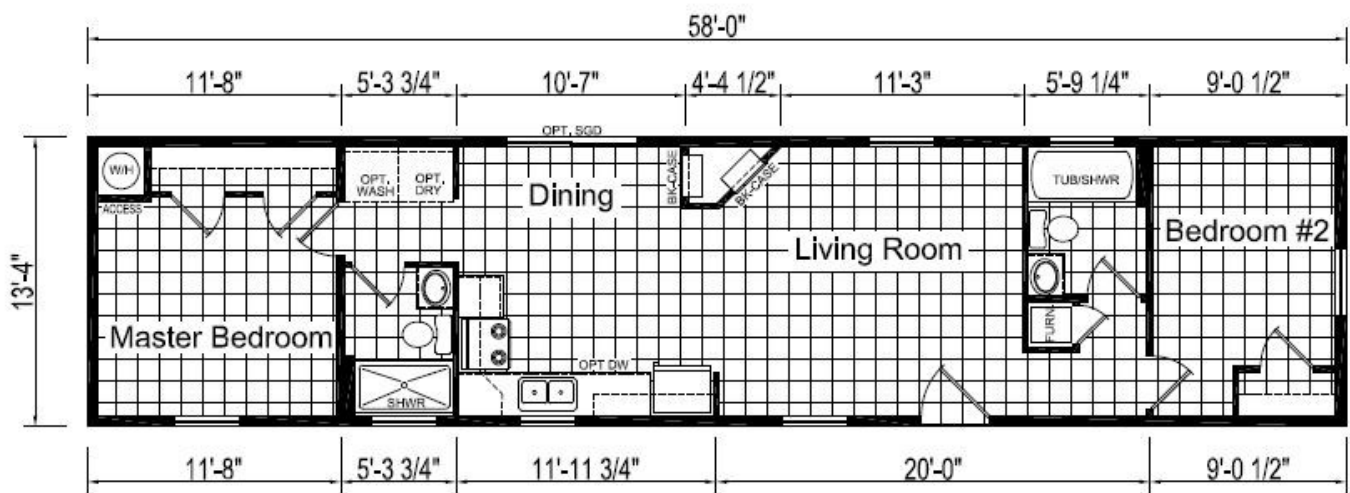

718 Wilson St  
Brewer, ME 04412  
(207) 989-2337



\*Model Pricing Subject to Change Without  
Notice Due to Market Volatility

**\$77,690 AS SHOWN**

# \$77,690



**ShowcaseHomesOfMaine.com**

**"Custom Modular Home Builder"**

# OPTIONS

## BASE PRICE

**\$70,566.00**

### Options:

<b>Maine Package:</b> 40LB Roof (16" O.C.), OSB Sheathing, Ice Guard, Pier Savers, Wind Wrap, Furnace Stack Ext, NE Safety Switch, Well Circuit Conduit, Combo CO2 & Smoke Detectors.	\$3,095.00
Deluxe Molding Throughout	STD
Deluxe Siding Upgrade - Brunswick	\$870.00
R-30 Roof Insulation	\$199.00
R-22 Floor Insulation	\$235.00
R-19 Wall Insulation (2"x6" Walls)	STD
Lino Throughout	\$299.00
18 Cu Ft Fridge, Gas Range	STD
Dishwasher *Please note that appliances may not be available at time of order due to widespread shortages; see your sales rep for details	\$425.00
Storm Door @ Front Door	\$279.00
Sliding Glass Door @ Dining Room	\$225.00
Transom Window @ Both Baths	\$180.00
100 Amp Long Box Electrical Panel	\$60.00
(2) Cable TV Jacks	\$50.00
Ceiling Fan @ Living Room	\$159.00
Exterior Faucet	\$55.00
Wood Cabinet Doors and Stiles	\$495.00
Shower Stall @ Master Bath	\$299.00
Single Lever Faucets	\$199.00
Water Shut Offs Throughout	STD
Stainless Steel Kitchen Sink	STD
Options total	\$7,124.00
Base plus Options	\$77,690.00

## SELLING PRICE

**\$77,690.00**

\*\*Windzone II add \$1,500



**EAGLE RIVER HOMES**



**ShowcaseHomesOfMaine.com**

**"Custom Modular Home Builder"**

[www.showcasehomesofmaine.com](http://www.showcasehomesofmaine.com)